

**Holman-Hankins-Bowker & Waud
Funeral Service**

(503) 656-2661

715 7th Street - Oregon City, OR 97045

www.waudsfuneralservice.com

info@waudsfuneralservice.com

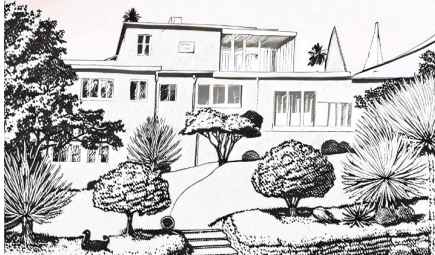

General Price List

Office Hours

**Monday—Friday
8:30AM - 4:30PM**

**Saturday, Sunday and Holidays
By appointment only**

The goods and services shown below are those we can provide to our customers. You may choose only the items you desire. However, any funeral arrangements you select will include a charge for our basic services and overhead. If legal or other requirements mean you must buy any items you did not specifically ask for, we will explain the reason in writing on the statement we provide describing the funeral goods and services you selected.

NOTICE TO CONSUMER: These disclosures are made in compliance with the requirements for disclosure set forth by the Federal Trade Commission; revised July 19, 1994. The General Price List has been designed according to the guidelines set forth in the Rule.

These prices are effective as of
January 1, 2025
and subject to change

PACKAGED SELECTIONS

We offer discounted packaged as an alternative to itemization for those who purchase their casket from us. If you do not wish a packaged selection, you may select funeral arrangements from the itemized options contained in this General Price List. The service packages include discounted services with the exception of our Basic Services of Funeral Director and Staff, which is not discounted. Over-time charges are not included.

TRADITIONAL FUNERAL SERVICE PACKAGE **\$4390**

Includes Basic Services of Funeral Director and Staff (not discounted), Embalming/Refrigeration, Dressing and Casketing, Use of Facilities and Staff for Viewing (one half day prior to and the day of service), Funeral Service at our facility or other location, Committal Service, local transfer of remains to the funeral home, funeral hearse, service/flower vehicle, securing legal documents, online obituaries, filing additional forms, and complete use of funeral home facilities as needed.

TRADITIONAL CREMATION SERVICE PACKAGE **\$4390**

Includes the items listed in the Traditional Funeral Package without a Committal service, hearse, and with the inclusion of the Retort Fee. This package does not include charges for over 300lbs or Aqua Dissolution. A rental casket or casket of your choice may be needed at an additional fee.

GRAVESIDE BURIAL/CREMATION SERVICE ONLY **\$3990**

Includes everything listed in the Traditional Funeral Package with the exception of the service in our chapel or your location and a service/flower vehicle. All services will instead be held at and conclude at the graveside.

MEMORIAL GATHERING ONLY PACKAGE **\$3090**

This package includes either a **Direct Cremation or Immediate Burial** and the use of our chapel for a simple memorial gathering where the deceased will not be present. No services will be held at the cemetery or crematory. This package does not include charges for over 300lbs or Aqua Dissolution.

CREMATION OR BURIAL WITH FORMAL VIEWING **\$3090**

Includes all items listed with **Direct Cremation or Immediate Burial** in addition to setting features, dressing and use of a viewing room for up to four hours. Embalming is included if requested. This package does not include charges for over 300lbs or Aqua Dissolution. A casket/rental casket may be needed at an additional fee.

CREMATION OR BURIAL WITH SIMPLE VIEWING **\$2290**

Includes all items listed with **Direct Cremation or Immediate Burial** in addition to a 30 minute viewing at the arrangement meeting without any preparation, dressing, embalming, setting features, etc. This package does not include charges for over 300lbs or Aqua Dissolution.

BASIC SERVICES OF FUNERAL DIRECTOR AND STAFF AND OVERHEAD

Our professional service charge includes, but is not limited to: **\$2095**

- 24-hour availability of staff 365 days a year to respond to the initial request for our services.
- Consultation with the family and/or responsible party for the arrangement of services selected.
- Completing and filing the death certificate.
- Ordering the initial batch of death certificates.
- Notifying Social Security.
- Coordinating with the cemetery or crematory or other parties involved in the final disposition of the deceased.
- A proportionate share of the taxes, license fees, utilities, and business expenses required to serve the public.

This fee for our basic services and overhead will be added to the total cost of the funeral arrangements you select. (This fee is already included in our charges for direct cremations, immediate burials, and forwarding or receiving remains.)

EMBALMING **\$485**

Except in certain special cases, embalming is not required by law. Embalming may be necessary, however, if you select certain funeral arrangements, such as a funeral with viewing. If you do not want embalming, you usually have the right to choose an arrangement that does not require you to pay for it, such as direct cremation or immediate burial.

OTHER PREPARATION OF THE BODY

- Washing and Disinfecting of remains **\$195**
- Dressing an embalmed body **\$195**
- Dressing an unembalmed body **\$395**
- Undressing after service/viewing (to return clothing) **\$50**
- Cosmetic work, hairdressing or grooming and casketing **\$200+**
- Special care following an autopsy. **\$150-\$550**
- Remove Pacemaker **\$150**

USE OF THE FACILITIES --- USE OF STAFF

This is a list of some of the general facilities we provide to each of our families. Additional usage of our facility can be arranged with our funeral directors and staff.

- Use of facilities and staff for viewing per half day. **\$195**
- Use of facilities and staff for funeral ceremony. **\$895**
- Use of facilities and staff for memorial service. **\$895**
- Use of facilities and staff for a reception following a Traditional Service. **\$395**
- Use of facilities and staff for a reception only **\$895**
- Use of equipment and staff for graveside service **\$785**
- Use of equipment and staff for a committal following service **\$395**
- Refrigeration Preservation per day after first 24 hours. **\$195**
- Overtime Charge Saturday before 12PM. **\$350**
- Overtime Charge on Saturday after 12PM **\$450**
- Overtime Charge on Sunday or any day after 5PM **\$550**
- Split Service Charge **\$150**
- Mailing Cremated Remains (within the USA) **\$200+**
- Transfer of cremated remains into urn. (included with our urns) **\$45**
- Taking thumb/finger prints (included with our jewelry) **\$45**
- Retort Fee **\$395**
- Rush Cremation (if available) **\$150**
- Over 300lbs but less than 400lbs cremation weight charge **\$350**
- Charges for services not mentioned. **Please Ask**

AUTOMOTIVE EQUIPMENT / TRANSFER

There is an additional mileage charge of \$3.50 for each loaded mile outside the local service radius of 15 miles and within 75 miles of the funeral home. Outside of the 75 mile radius, additional charges will apply and will be discussed with you before scheduling the transfer.

- Transfer of Remains to Funeral Home \$495
- Over 300lbs additional transfer fee \$145+
- Hearse \$475
- Alternate Delivery Vehicle (ie. Flower van) \$475
- Procession with 2 motor escorts and up to 20 cars \$850

MEMORIAL MERCHANDISE

- Acknowledgment Cards / 25 \$30
- Register Book prices \$25, 55, 70, 110
- Memorial DVD (up to 100 jpeg photo's and 4 legal songs) \$250
- Memorial Folders See Director
- Prayer Cards See Director
- Grave Markers & Monuments & Vases See Director
- Temporary Grave Marker \$50
- Crucifix \$25

MISCELLANEOUS MERCHANDISE

- Air / Ground Shipping Tray {required by the airlines} \$395
- Air / Ground Shipping Combination Tray {required by the airlines} \$495
- Standard Duty Body Containment Pouch \$85
- Heavy Duty Body Containment Pouch \$185

CASH ADVANCE ITEMS

Cash advance items include those items the Funeral Home must pay for in advance. These prices will be equal to the current cost to us. They include, but are not limited to:

- Oregon State Filing Fee (for Death Certificates) \$30
- Oregon Certified Copy of Death Certificates \$25

Other possible cash advance items are not listed as charges will vary. They include but not limited to: honorariums for clergy and/or musicians, paid obituary notices, flowers, common carrier transportation charges and charges at other funeral homes, etc.

FORWARDING OF REMAINS TO ANOTHER FUNERAL HOME \$1995

Our charge includes the transfer of the deceased from the place of death to the funeral home, refrigeration or embalming if requested, minimum services of the funeral director and staff (proportionate share), necessary authorizations, permits and other legal documents, and transportation to the airport.

NOTE: This charge does not include the casket, additional services of the funeral director and staff, use of facilities for visitation and/or rites or funeral ceremonies prior to the forwarding of the deceased remains. Also it does not include the shipping charge, the required airline shipping container or cash advance items. Shipping may also be available by ground transportation.

RECEIVING REMAINS FROM ANOTHER FUNERAL HOME \$1495

This charge includes transportation from the local airport or railroad station to the funeral home, holding the remains while final arrangements are concluded (up to 3 days), transportation to the place of final disposition. This also includes the minimum services of the funeral director and staff (proportionate share).

NOTE: Funeral rites or ceremonies, cemetery charges, merchandise or cash advance items. Those or other items/services can be added.

IMMEDIATE BURIAL OR ENTOMBMENT \$1970 to \$13305

An Immediate Burial is the disposition of human remains by earth burial or crypt entombment, without embalming, viewing, or ceremony. Our Immediate Burial charge, without ceremony, includes basic services of funeral director and staff and overhead (proportionate share), transfer of remains to funeral home (15 mile radius), use of refrigeration if required, sheltering for up to 3 days, and transportation to local cemetery. Our services do not include a casket, cemetery charges, outer burial container or cash advance items. **NOTE: Most cemeteries require embalming for above ground crypt entombment. Charges for embalming are in addition to our charges for Immediate Burial or Entombment.**

IMMEDIATE BURIAL OPTIONS

- Immediate Burial with casket provided by purchaser \$1970
- Immediate Burial with Whitman casket. \$3265
- Immediate Burial with any casket selected. \$1970 + Casket Cost

DIRECT CREMATION \$1970 - \$12,005

Our charge for a direct cremation (without ceremony) includes: basic services of funeral director and staff; a proportionate share of overhead costs; removal of remains; transportation to crematory; necessary authorizations; and cremation if relevant. Charges for over 300lbs are not included. No additional services are included with or can be added to the Direct Cremation.

If you want to arrange a direct cremation, you can use an alternative container. Alternative containers encase the body and can be made of materials like fiberboard or composition materials (with or without an outside covering). The containers we provide are a cardboard container or an unfinished wood box.

DIRECT CREMATION OPTIONS

- Direct Cremation with container provided by purchaser. \$1970
- Direct Cremation with cardboard container. \$1970
- Direct Cremation with Rental Casket use. \$2965
- Direct Cremation with any wood casket in our selection. \$1970 + Casket Cost

*****The casket will need to be partially disassembled in order to fit into the retort for the cremation process.**

CASKETS \$1295-\$11,335

A complete price list will be provided at the funeral home. This list includes alternative containers that may not be suitable for burial as they may not meet the minimum cemetery requirements.

OUTER BURIAL CONTAINERS \$1395 - \$6095

A complete price list will be provided at the funeral home.

METHODS OF PAYMENT

Payment for services selected is expected at the initial arrangement conference. Payment may be made by Cash, Check, Master Card, Visa, Discover Card or partial Insurance Assignment. We are unable to bill estates or accept full payment from outside insurance assignments.

NOTES: